



Deddington,  
Oxfordshire



## Deddington, Oxfordshire

**\*\*50% SHARED EQUITY\*\***

A charming two-bedroom semi-detached house with private parking, in a popular position within walking distance of the village centre.

The highly regarded town of Deddington offers many amenities including several shops providing for everyday needs, Post Office, Health & Community Centres, library, hotels and restaurants, recreation ground and the Church of St Peter and St Paul. There is a gym located on Clifton Road.

Also, within the town there is the Church of England primary school plus Deddington falls within the Warriner catchment for secondary education. Further comprehensive facilities can be found in both Oxford and Banbury whilst access to the M40 motorway can be gained at Junctions 10 or 11. Mainline stations are also available from both Banbury and Bicester.







## The Property Briefly Comprises of:

- 50% SHARED EQUITY
- Open plan Living/Kitchen/Dining Room
- Ground Floor Cloakroom
- Integrated storage cupboards
- Two Double Bedrooms
- Family Bathroom
- Rear Garden
- Allocated Parking



Guide Price: £170,000

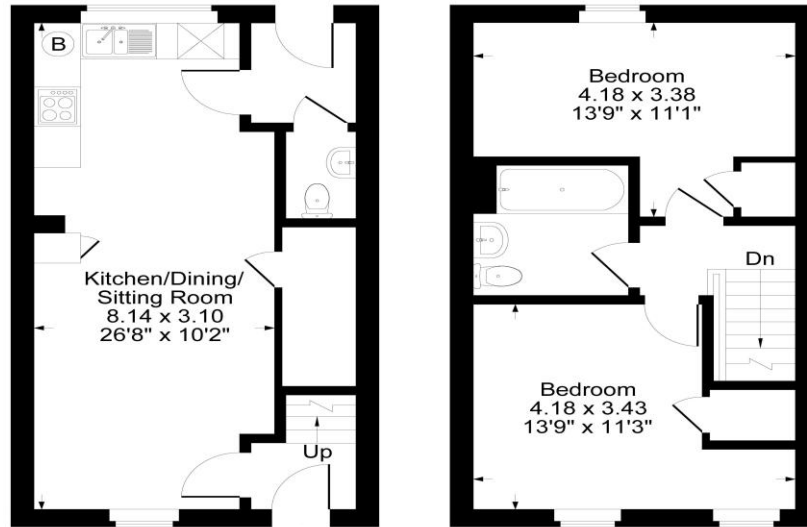

Ground Floor

First Floor

Approximate Gross Internal Area  
 Ground Floor = 33.78 sq m / 364 sq ft  
 First Floor = 33.78 sq m / 364 sq ft  
 Total Area = 67.56 sq m / 728 sq ft  
 Illustration for identification purposes only,  
 measurements are approximate, not to scale.

**Local Authority:**  
 Cherwell District Council

**Council Tax Band: C**  
 (Subject to change after completion)

**Tenure:** Leasehold  
 Assured Rent: £436.35 pcm  
 Service Charges: £11.62 pcm  
 (This includes building insurance)

Total monthly charges due to  
 Stonewater: £447.97

**Distances**  
 Banbury c. 6 miles  
 Chipping Norton c. 10 miles  
 Bicester c. 12 miles  
 Oxford c. 18 miles  
 Birmingham c. 58 miles  
 London c. 73 miles  
 M40 access J10 c. 7 miles, J11  
 c. 8 miles  
 London via Bicester c. 43 minutes

**Mark David**  
 ESTATE AGENTS  
 Sales • Lettings • Management

Market House, Market Place, Deddington, Oxfordshire  
 OX15 0SB  
 Tel: 01869 338898  
 Email: deddington@mark-david.co.uk  
[www.mark-david.co.uk](http://www.mark-david.co.uk)



**Important Notice**

Mark David Estate Agents for themselves and their clients give notice that:-  
 1. They are not authorised to make or give representation or warranty in relation to this property, either on their own behalf or on behalf of the Seller. They assume no responsibility for any statement made in these particulars. These particulars do not form part of any offer or contract and must not be relied upon as statements or representations of fact.  
 2. Whilst every attempt has been made to ensure the accuracy of the floorplan contained here, measurements of doors, windows, rooms and any other items are approximate and no responsibility is taken for any error, omission, or mis-statement.  
 3. All areas, measurements or distances are approximate. The particulars are intended for guidance only and are not necessarily comprehensive. A wide angle lens may have been used in photography. Mark David Estate Agents have not tested appliances or services and it should not be assumed that the property has all necessary planning, building regulation and other consents. Buyers must satisfy themselves with the property by inspection or otherwise.  
 4. Reference to any mechanical or electrical equipment does not constitute a representation that such equipment is capable of fulfilling its function and prospective Buyers must make their own enquiries.  
 5. They have no responsibility for any expenses or costs incurred by prospective Buyers in inspecting properties which have been sold, let or withdrawn. Applicants are advised to contact the Agent to check availability and any other information of particular importance to them, prior to inspecting the property, particularly if traveling some distance.