



Moreton Pinkney

## Moreton Pinkney

A Rarely Available Three Bedroom Extended Detached Bungalow with Own Driveway to Car Port and Garage with Private Enclosed Rear Gardens.

Moreton Pinkney is an attractive rural village comprising mainly of ironstone properties, set in undulating south Northamptonshire countryside.

Amenities in the village include St Mary's church, village hall and playground. There is a village shop in the neighbouring village of Sulgrave.

Primary school at Culworth with Chenderit senior school at Middleton Cheney. School buses from the village (at time of print, September 2022). Private preparatory schools include Carrdus (Overthorpe), St. John's Priory (Banbury), Winchester House (Brackley) and Beachborough (Westbury). Senior independent schools include Rugby, Stowe, Northampton High (girls), Bloxham and Tudor Hall (girls).





## The Property Briefly Comprises of:

- Entrance Hall
- Cloakroom
- Sitting Room
- Dining Room
- Kitchen / Breakfast Room
- Integrated Appliances
- Three Bedrooms
- Shower Room
- Driveway and Car Port
- Detached Garage
- Rear Garden

Guide Price: £490,000

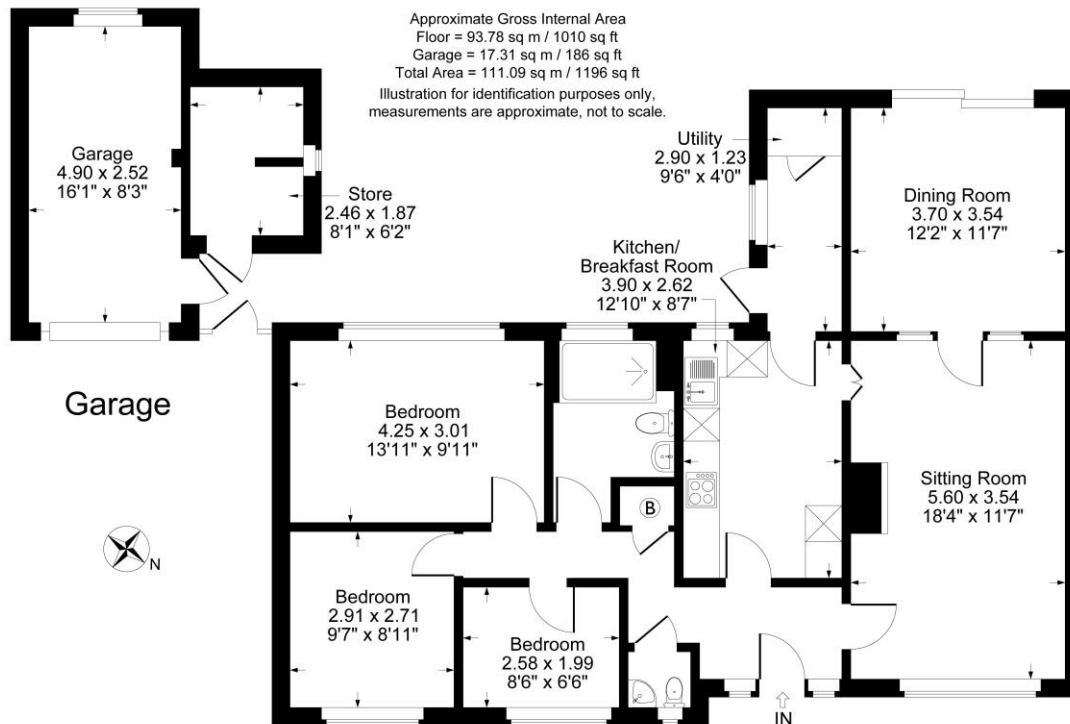

**Local Authority:**  
 South Northamptonshire Council

**Council Tax Band: D**

(Subject to change after completion)

**Tenure**  
 Freehold

**Distances**  
 Banbury c.10 miles  
 Towcester c.10.5 miles  
 Brackley c.9.6 miles  
 M40 (J11) Banbury and M1 (J15a)  
 Northampton.  
 Banbury to London/Marylebone c.56  
 minutes  
 Milton Keynes to London/Euston  
 c.35 minutes

**Mark David**  
 ESTATE AGENTS  
 Sales • Lettings • Management

Market House, Market Place, Deddington, Oxfordshire  
 OX15 0SB  
 Tel: 01869 338898  
 Email: deddington@mark-david.co.uk  
[www.mark-david.co.uk](http://www.mark-david.co.uk)

**Important Notice**

Mark David Estate Agents for themselves and their clients give notice that:-

1. They are not authorised to make or give representation or warranty in relation to this property, either on their own behalf or on behalf of the Seller. They assume no responsibility for any statement made in these particulars. These particulars do not form part of any offer or contract and must not be relied upon as statements or representations of fact.
2. Whilst every attempt has been made to ensure the accuracy of the floorplan contained here, measurements of doors, windows, rooms and any other items are approximate and no responsibility is taken for any error, omission, or mis-statement.
3. All areas, measurements or distances are approximate. The particulars are intended for guidance only and are not necessarily comprehensive. A wide angle lens may have been used in photography. Mark David Estate Agents have not tested appliances or services and it should not be assumed that the property has all necessary planning, building regulation and other consents. Buyers must satisfy themselves with the property by inspection or otherwise.
4. Reference to any mechanical or electrical equipment does not constitute a representation that such equipment is capable of fulfilling its function and prospective Buyers must make their own enquiries.
5. They have no responsibility for any expenses or costs incurred by prospective Buyers in inspecting properties which have been sold, let or withdrawn. Applicants are advised to contact the Agent to check availability and any other information of particular importance to them, prior to inspecting the property, particularly if traveling some distance.

